

## FWFOC.EW1 Exterior Wall Insulation and Finish Systems

Page Bottom

### Exterior Wall Insulation and Finish Systems

See General Information for Exterior Wall Insulation and Finish Systems

#### System No. EW1

May 02, 2006

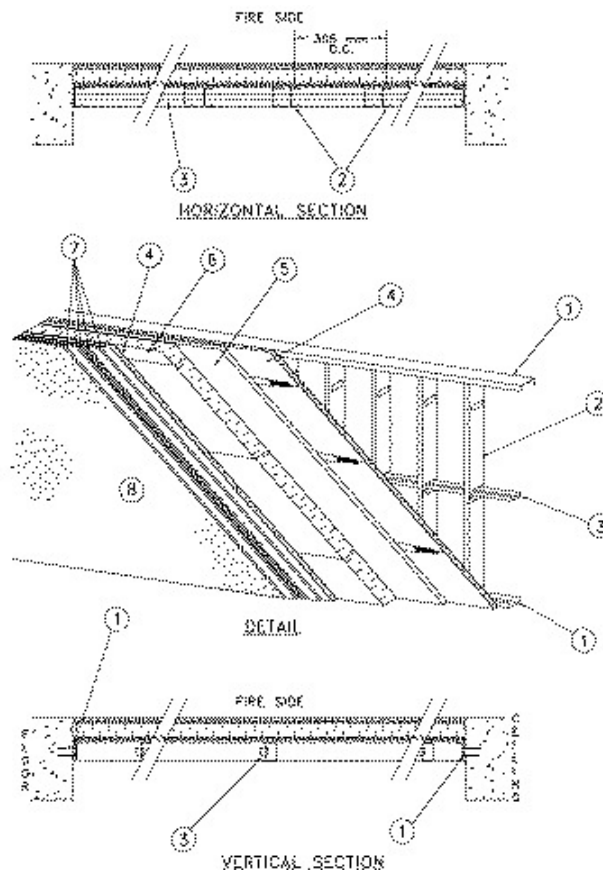

1. **Floor and Ceiling Tracks** — 95 mm deep by 32 mm wide channel, 0.91 mm thick galvanized steel, attached to masonry or concrete with fasteners spaced 600 mm OC.
2. **Steel Studs** — 95 mm deep by 32 mm wide channel, with 6 mm lip on each flange tip, 0.91 mm thick galvanized steel, fastened to the floor and ceiling tracks, spaced 305 mm apart. Studs have 38 mm cutouts.
3. **Bracing** — 38 mm wide by 12 mm deep channels, 1.52 mm thick galvanized steel are inserted in the stud cutouts at 1500 mm OC.
4. **Mineral and Fibre Boards** — CERZC (Guide No. 40U18.13). Nominal 12.7 mm thick "Perma Base" cement boards fastened to the studs by means of Type S drywall screws, 30 mm long and fastened through the insulation board (Item 6) to the studs by means of 4 mm diameter self-tapping screws 95 mm long, spaced 200 mm OC along board edges and 300 mm OC in the field of the board. 50 mm wide mesh tape and mastic compound designated as Durabond Mastic 100 plaster was used to fill the joints between the boards over the base layer of the cement board.

**UNIFIX INC**

- **5. Component for Exterior Wall Insulation and Finish System, Coating** — FWFXC (Guide No. 40 U23.5.3). Base coat adhesive trowelled onto the exposed side of the mineral and fibre board at the rate of 3.4 kg/m<sup>2</sup>. The base coat is prepared by mixing 3 parts by weight of Durex patch coat powder with 1 part by weight of Durex liquid bond.

**DURABOND PRODUCTS LTD**

- 6. **Rigid Roof Insulation** — 50 mm thick by 610 mm wide by 1220 mm long Type 1 expanded polystyrene, attached to the studs by means of 60 mm long self-tapping screws and washers at 305 mm OC.

- **7. Component for Exterior Wall Insulation and Finish System, Coating** — FWFXC (Guide No. 40 U23.5.3). Two coats of Durex Intermediate coating applied at the rate of 3.4 kg/m<sup>2</sup> over the second layer of cement board (Item 4) with vertical strips of a light reinforcing fabric (0.17 kg/m<sup>2</sup>) pressed by a trowel on the wet surface of the first coating.

**DURABOND PRODUCTS LTD**

- **8. Component for Exterior Wall Insulation and Finish System, Finish Coat** — FWFXC (Guide No. 40 U23.5.3). Durex Architectural coating applied at the rate of 2 kg/m<sup>2</sup> on top of the intermediate coating (Item 7). Average thickness of this coat is 1.25 mm.

**DURABOND PRODUCTS LTD**

Last Updated on 2006-05-02

[Questions?](#)

[Print this page](#)

[Notice of Disclaimer](#)

[Page Top](#)

Copyright © 2010 Underwriters Laboratories of Canada Inc.

The appearance of a company's name or product in this database does not in itself assure that products so identified have been manufactured under ULC's Follow-Up Service. Only those products bearing the ULC Mark should be considered to be Listed and covered under ULC's Follow-Up Service. Always look for the Mark on the product.

ULC permits the reproduction of the material contained in the ULC Online Directories subject to the following conditions: 1. The Guide Information, Designs and/or Listings (files) must be presented in their entirety and in a non-misleading manner, without any manipulation of the data (or drawings). 2. The statement "Reprinted from the ULC Online Directories with permission from Underwriters Laboratories of Canada Inc." must appear adjacent to the extracted material. In addition, the reprinted material must include a copyright notice in the following format: "Copyright © 2010 Underwriters Laboratories of Canada Inc."

An independent organization working for a safer world with integrity, precision and knowledge.

