

**BXUVC.W485
Fire Resistance Ratings**

Page Bottom

Fire Resistance Ratings

[See General Information for Fire Resistance Ratings](#)

Design No. W485

August 30, 2010

Assembly Rating - 2 h (Fire Exposure from the Interior Side)

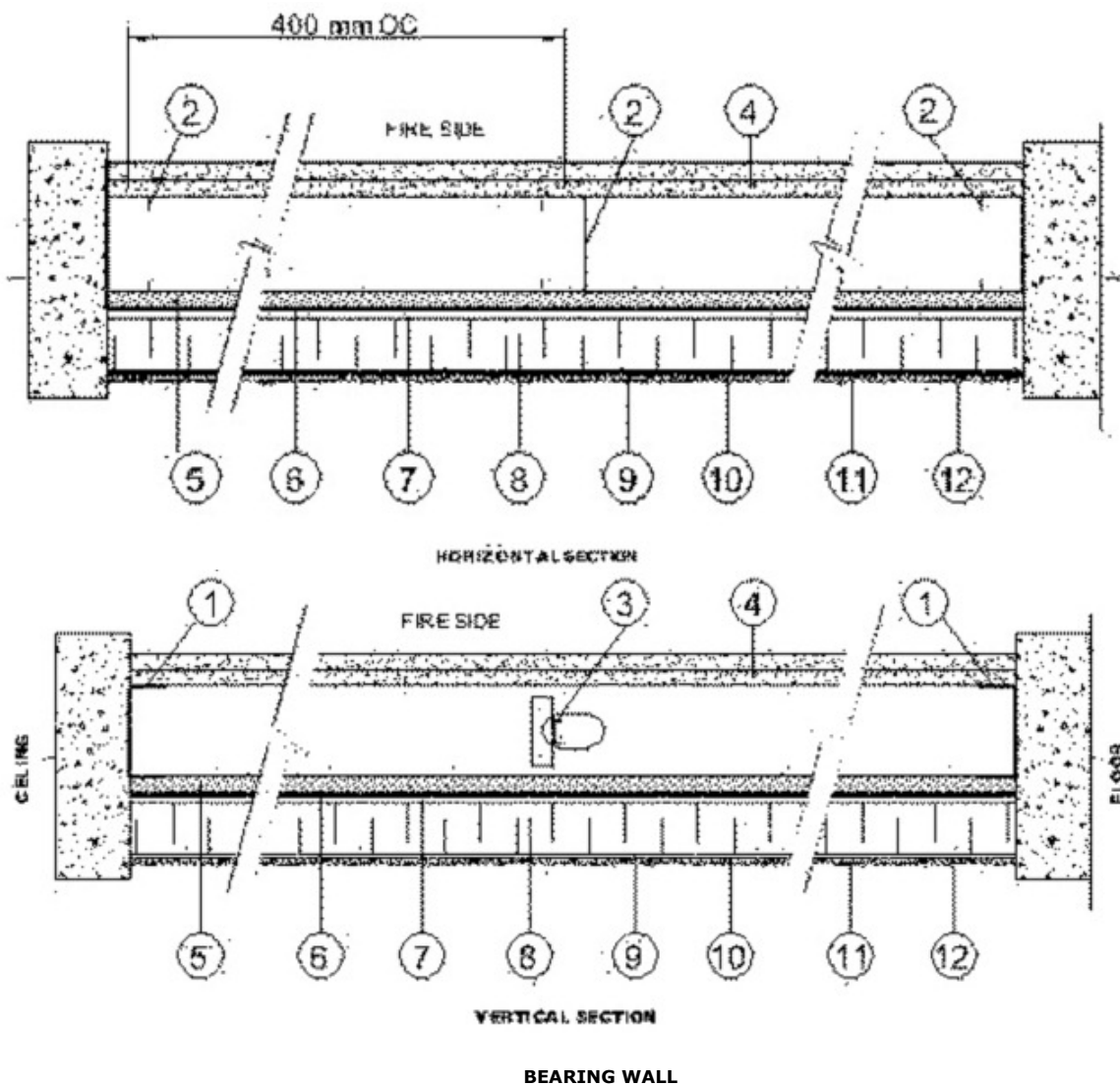

1. **Floor and Ceiling Track** — Galvanized steel channels 1.087 mm thick (minimum delivered thickness), 92 mm deep with 30 mm wide flanges attached to masonry or concrete with fasteners spaced at 800 mm OC.

2. **Steel Studs** — Galvanized steel channels 0.836 mm thick (minimum delivered thickness), 92 mm deep with 41 mm wide flanges and 12.7 mm lips. The studs are fastened to the floor and ceiling tracks at 406 mm OC with self tapping steel

screws. The studs have 38 mm wide cutouts at 610 mm OC along the web of the channels.

3. **Bracing** — Galvanized steel channels 1.087 mm thick (minimum delivered thickness), 38 mm deep with 12.7 mm wide flanges inserted through the stud cutouts at 1220 mm OC. The bracing is attached to the studs with clip angles and self-tapping steel screws.

4. **Gypsum Wallboard** — (CKNXC). "ProRoc Type C", 12.7 mm thick, 1200 mm wide, applied vertically in two layers. Inner layer attached to studs and track with 25.4 mm long Type S drywall screws spaced 305 mm OC along board edges and in the field, 25.4 mm from the board ends. Outer layer attached using 41 mm long Type S drywall screws spaced 305 mm OC along board edges and in the field of the board with the edge screws located 38 mm from the board ends. Face layer joints offset 406 mm from inner layer joints. Outer layer joints covered with joint tape and two coats of joint compound. Screw heads covered with two coats of joint compound.

CERTAINTED GYPSUM CANADA INC

5. **Gypsum Wallboard** — (CKNXC). "Type GlasRoc Sheathing Type X - Type EGRG" boards, 1220 mm wide (minimum) by 15.9 mm thick, installed vertically with joints centered on wall studs. The boards are fastened to the studs with 25.4 mm long Type S drywall screws spaced at 203 mm OC along the edges and in the field of the boards. The ends of the board are fastened to the track at 178 mm and 229 mm OC ensuring that the board is not fastened at the stud/track junction. The joints between boards to be covered with 120 mm wide fibreglass seam tape and covered with a 250 mm wide layer of Green Guard Plus (See Item 6).

CERTAINTED GYPSUM CANADA INC

6. **Component for Exterior Wall Insulation and Finish System** — (FWFXC). A layer of "Durex Green Guard Plus" membrane is applied at a minimum rate of 0.93 kg/m² over the entire surface of the wallboard.

DURABOND PRODUCTS LTD

7. **Component for Exterior Wall Insulation and Finish System** — (FWFXC). A coat of adhesive is installed using a notched trowel over the membrane (Item 6) at a min net rate of 3.95 kg/m². The adhesive consists of a mixture of 2.1 parts by weight of "Durex Flexcrete" liquid to 1 part by weight of "Durex Flexcrete B" powder.

DURABOND PRODUCTS LTD

8. **Insulation** — Type 1, expanded polystyrene insulation boards, 150 mm thick (max) installed horizontally with vertical and horizontal joints offset from those in the wallboard. The insulation boards are then pressed firmly onto the adhesive (Item 7).

9. **Component for Exterior Wall Insulation and Finish System** — (FWFXC). The insulation boards (Item 8) are rasped and a layer of base coat is applied over the insulation boards at a minimum wet application rate of 4.85 kg/m². The base coat consists of a mixture of 4.5 parts by weight of "Durex Uniplast" powder to 1.0 part by weight of "Durex Acrybond S" liquid. The surface of this layer of base coat is to be lightly rasped after curing is complete.

DURABOND PRODUCTS LTD

10. **Reinforcing Fabric** — A layer of fibreglass mesh reinforcement with an area density of 0.24 kg/m² is installed vertically with a 100 mm overlap between strips. The mesh is to be trowelled into the uncured top surface of the first layer of base coat (Item 9).

11. **Component for Exterior Wall Insulation and Finish System** — (FWFXC) A second layer of base coat is applied at a min wet application rate of 3.1 kg/m². The base coat consists of a mixture of 4 parts by weight of "Durex Uniplast" powder to 1.0 part by weight of "Durex Acrybond S" liquid.

DURABOND PRODUCTS LTD

12. **Component for Exterior Wall Insulation and Finish System** — (FWFXC). One layer of premixed "Durex Venetian Fine Coating" applied at a min wet application rate of 2.18 kg/m² over base coat.

DURABOND PRODUCTS LTD

Last Updated on 2010-08-30

[Questions?](#)

[Print this page](#)

[Notice of Disclaimer](#)

[Page Top](#)

[Copyright © 2011 Underwriters Laboratories of Canada Inc.](#)

The appearance of a company's name or product in this database does not in itself assure that products so identified have been manufactured under ULC's Follow-Up Service. Only those products bearing the ULC Mark should be considered to be Listed and covered under ULC's Follow-Up Service. Always look for the Mark on the product.

ULC permits the reproduction of the material contained in the ULC Online Directories subject to the following conditions: 1. The Guide Information, Designs and/or Listings (files) must be presented in their entirety and in a non-misleading manner, without any manipulation of the data (or drawings). 2. The statement "Reprinted from the ULC Online Directories with permission from Underwriters Laboratories of Canada Inc." must appear adjacent to the extracted material. In addition, the reprinted material must include a copyright notice in the following format: "Copyright © 2011 Underwriters Laboratories of Canada Inc."

An independent organization working for a safer world with integrity, precision and knowledge.

